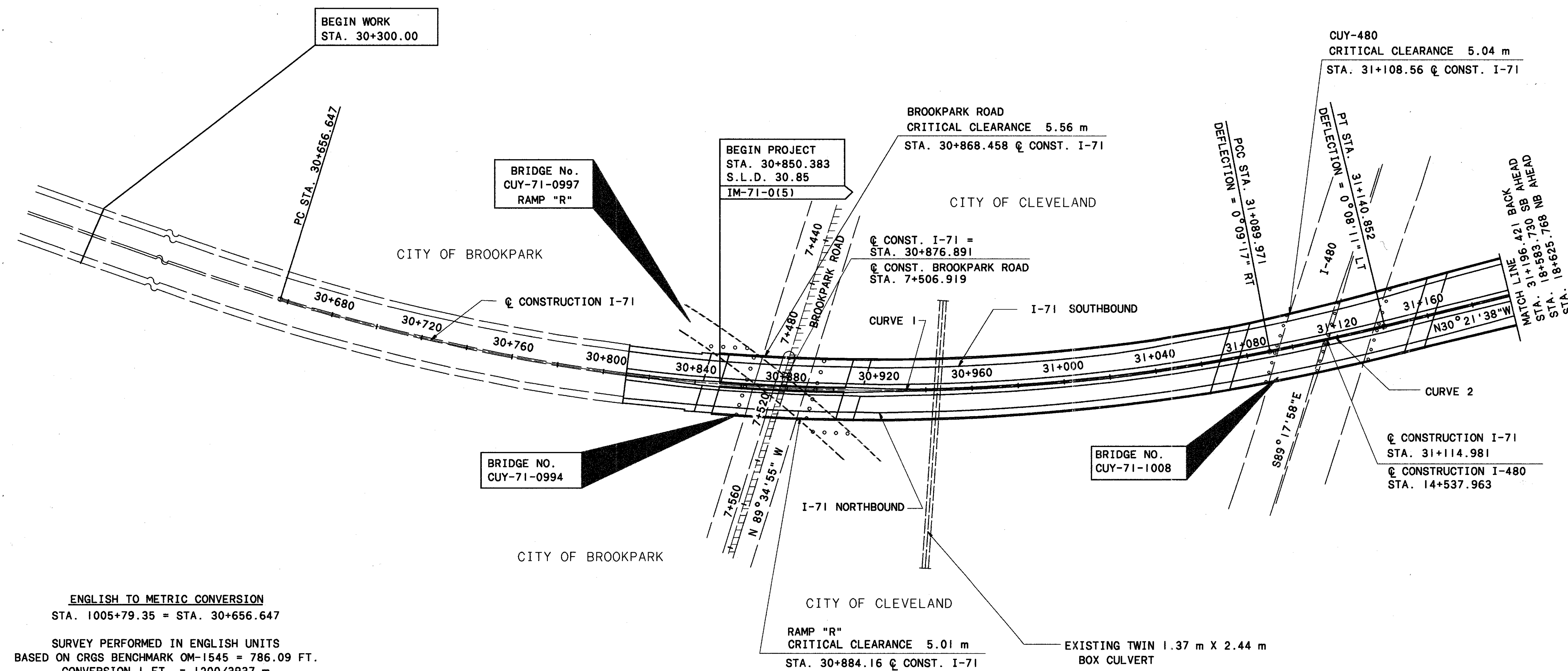

ALCULATED	CHECKED
SNR	

SCHEMATIC PLAN

CUY-71-9.94

$$\frac{2}{28}$$

ENGLISH TO METRIC CONVERSION

STA. 1005+79.35 = STA. 30+656.647

SURVEY PERFORMED IN ENGLISH UNITS
BASED ON CRGS BENCHMARK OM-1545 = 786.09 FT.
CONVERSION 1 FT. = 1200/3937 m

CURVE 1 I-71
P.I. STA. 30+877.868
 $\Delta = 28^{\circ}26'00''$ LT
R = 873.190 m
T = 221.221 m
L = 433.324 m
E = 27.587 m
 $e_{max} = 0.06$
P.C. STA. 30+656.647
P.T. STA. 31+089.971

DEFLECTION WITHOUT CURVE
P.I. STA. 31+089.971
DEFLECTION = 0°09'17"

CURVE 2 I-71
P.I. STA. 31+115.416
 $\Delta = 02^{\circ}30'14''$ LT
R = 1164.302 m
T = 25.445 m
L = 50.882 m
E = 0.278 m
 $e_{max} = 0.06$
P.C. STA. 31+089.971
P.T. STA. 31+140.852

DEFLECTION WITHOUT CURVE
P.I. STA. 31+140.852
DEFLECTION = 0°08'11" LT